

NUST – LMS

Backup/ Restore of LMS course

A teacher can create a backup or download an existing backup for safe keeping, or for use on another course.

How to take backup of your course:

1. Open the course you want to take the backup.

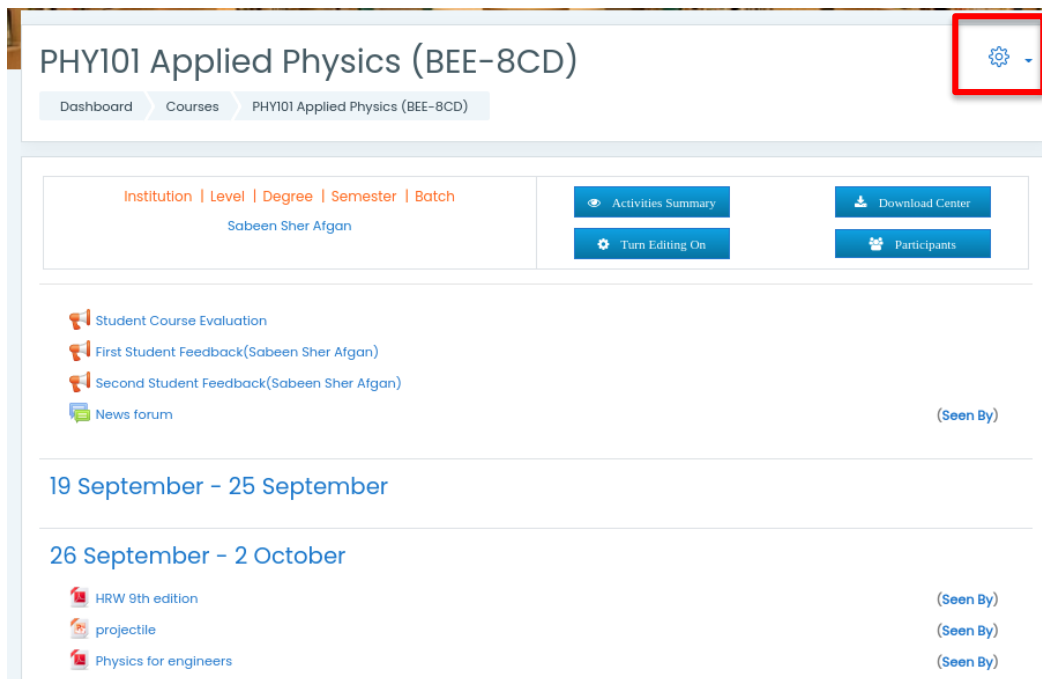

PHY101 Applied Physics (BEE-8CD)

Dashboard Courses PHY101 Applied Physics (BEE-8CD)

Institution | Level | Degree | Semester | Batch
Sabeen Sher Afgan

Activities Summary Download Center
Turn Editing On Participants

Student Course Evaluation
First Student Feedback(Sabeen Sher Afgan)
Second Student Feedback(Sabeen Sher Afgan)
News forum (Seen By)

19 September – 25 September

26 September – 2 October

HRW 9th edition (Seen By)
projectile (Seen By)
Physics for engineers (Seen By)

2. Click on the “Action menu” (The gear icon) to expand the menu.

NUST – LMS

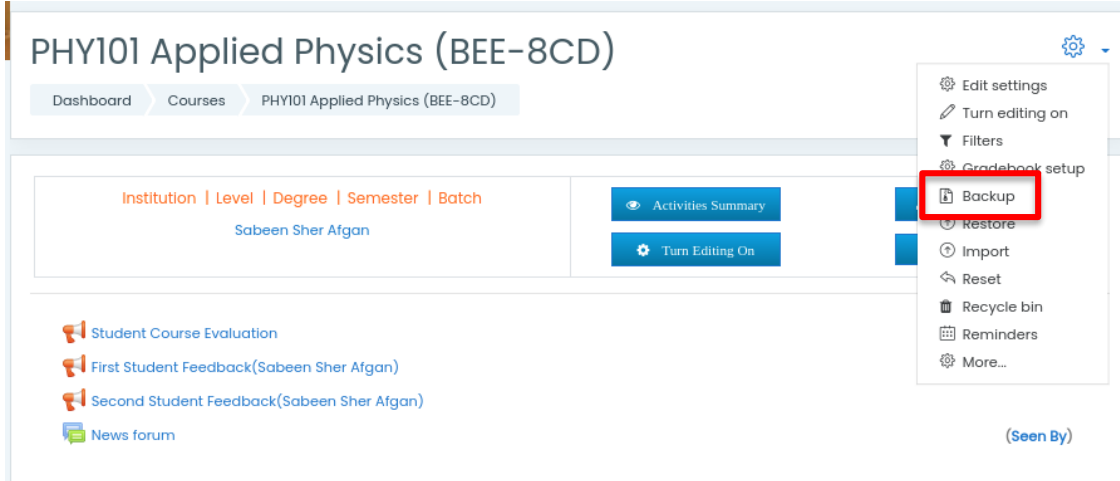

3. Click on the “Backup” link and check all the checkboxes of the activities you want to include in your backup and click on the “Next” button.

NUST – LMS

Backup course: PHY101-F'16 BEE-8CD

Dashboard > Courses > PHY101 Applied Physics (BEE-8CD) > Turn editing off > Backup

1. Initial settings ▶ 2. Schema settings ▶ 3. Confirmation and review ▶ 4. Perform backup ▶ 5. Complete

Backup settings

<input type="checkbox"/>	IMS Common Cartridge 1.1
<input type="checkbox"/>	Include enrolled users
<input checked="" type="checkbox"/>	Anonymize user information
<input type="checkbox"/>	Include user role assignments
<input checked="" type="checkbox"/>	Include activities and resources
<input type="checkbox"/>	Include blocks
<input type="checkbox"/>	Include filters
<input type="checkbox"/>	Include comments
<input type="checkbox"/>	Include badges
<input type="checkbox"/>	Include calendar events
<input type="checkbox"/>	Include user completion details
<input type="checkbox"/>	Include course logs
<input type="checkbox"/>	Include grade history
<input checked="" type="checkbox"/>	Include question bank
<input type="checkbox"/>	Include groups and groupings
<input checked="" type="checkbox"/>	Include custom fields

[Jump to final step](#) [Cancel](#) [Next](#)

4. After selection of the individual or all activities/ resources, click on the “Next” button.

NUST – LMS

1. Initial settings ▶ 2. Schema settings ▶ 3. Confirmation and review ▶ 4. Perform backup ▶ 5. Complete

Include:

Select
All / None (Show type options)

<input type="checkbox"/> General	User data	✖ 🔒
<input checked="" type="checkbox"/> Attendance 📅	-	✖ 🔒
<input checked="" type="checkbox"/> Student Course Evaluation 📅	-	✖ 🔒
<input checked="" type="checkbox"/> First Student Feedback(Sabeen Sher Afgan) 📅	-	✖ 🔒
<input checked="" type="checkbox"/> Second Student Feedback(Sabeen Sher Afgan) 📅	-	✖ 🔒
<input checked="" type="checkbox"/> News forum 📅	-	✖ 🔒
<input checked="" type="checkbox"/> 19 September – 25 September	User data	✖ 🔒
<input checked="" type="checkbox"/> 26 September – 2 October	User data	✖ 🔒
<input checked="" type="checkbox"/> HRW 9th edition 📅	-	✖ 🔒
<input checked="" type="checkbox"/> projectile 📅	-	✖ 🔒

5. Write the name of the backup file and click on the button “Perform Backup”.



NUST – LMS

1. Initial settings ▶ 2. Schema settings ▶ 3. Confirmation and review ▶ 4. Perform backup ▶ 5. Complete

Filename

Filename ⓘ

Backup settings

IMS Common Cartridge 1.1	✗
Include enrolled users	✗
Anonymize user information	✓ 
Include user role assignments	✗ 
Include activities and resources	✓

[Previous](#) [Cancel](#) [Perform backup](#)

6. The time for backup will depend on the size of contents included for backup.

Backup course: PHY101-F'16 BEE-8CD

[Dashboard](#) > [Courses](#) > [PHY101 Applied Physics \(BEE-8CD\)](#) > [Turn editing off](#) > [Backup](#)

1. Initial settings ▶ 2. Schema settings ▶ 3. Confirmation and review ▶ 4. Perform backup ▶ 5. Complete



1.36 secs – 88.06%

7. After completion of the backup, a successful backup message will appear.

NUST – LMS

Backup course: PHY101-F'16 BEE-8CD

Dashboard > Courses > PHY101 Applied Physics (BEE-8CD) > Turn editing off > Backup

1. Initial settings > 2. Schema settings > 3. Confirmation and review > 4. Perform backup > 5. Complete

The backup file was successfully created.

Continue

How to restore your course:

1. Open the course, when you want to restore the backup and select the “Restore” option from the dropdown menu of the course “Action menu”.

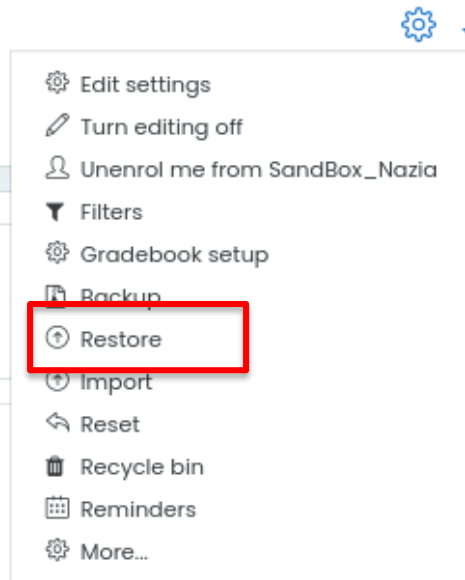

2. Backup file can be selected from your computer, the course backup area or your private backup area

NUST – LMS

Import a backup file

Files

Choose a file...



You can drag and drop files here to add them.

Restore

There are required fields in this form marked ⓘ.

Course backup area ⓘ

Filename	Time	Size	Download	Restore
backup-moodle2-course-sandbox_nazia-20120410-1323.mbz	Tuesday, 10 April 2012, 1:23 PM	167.3MB	Download	Restore
backup-moodle2-course-sandbox_nazia-20120410-1320.mbz	Tuesday, 10 April 2012, 1:21 PM	167.3MB	Download	Restore

Manage backup files

User private backup area ⓘ

Filename	Time	Size	Download	Restore
backup-of-PHY101-BEE8CD.mbz	Friday, 11 June 2021, 7:18 PM	90.5MB	Download	Restore
backup-moodle2-course-16779-test_course2020-20210324-1300-na.mbz	Wednesday, 24 March 2021, 1:00 PM	6.8MB	Download	Restore
backup-moodle2-course-3239-sandbox_nazia-20210316-1236-an.mbz	Tuesday, 16 March 2021, 12:39 PM	61.3MB	Download	Restore

- After selecting the backup file, click on the “Restore” button (for the backup file uploading from your computer system) and the link of respective “Restore” available for the desired backup file.

User private backup area ⓘ

Filename	Time	Size	Download	Restore
backup-of-PHY101-BEE8CD.mbz	Friday, 11 June 2021, 7:18 PM	90.5MB	Download	Restore

- All details of the backup will be displayed before you continue.

NUST – LMS

Module	Title	Userinfo
File	ampere law 2	✘
File	Faraday law 2	✘
File	assignment 3	✘
Included in backup (no user information)		
Module	Title	Userinfo
File	Faraday law 2	✘
File	maxwell equations	✘
Included in backup (no user information)		
Included in backup (no user information)		
Included in backup (no user information)		
Included in backup (no user information)		

Continue

- Select the “continue” option for “Restore into this course” and proceed to “Next”.

Restore into this course

Merge the backup course into this course

Delete the contents of this course and then restore

Continue

- Verify all the contents you want to restore into this course and click on the button “Perform restore”

Previous
Cancel
Perform restore

- The restore progress will be displayed.

NUST – LMS

SandBox_Nazia

Dashboard > Courses > SandBox_Nazia > Restore

1. Confirm ▶ 2. Destination ▶ 3. Settings ▶ 4. Schema ▶ 5. Review ▶ 6. Process ▶ 7. Complete

0.1 secs - 98.49%

The instance of this module does not exist The instance of this module does not exist The instance of this module does not exist

8. Successful restore message will appear, click on the “Continue” button to view all the restored contents in the new course.

SandBox_Nazia

Dashboard > Courses > SandBox_Nazia > Restore

1. Confirm ▶ 2. Destination ▶ 3. Settings ▶ 4. Schema ▶ 5. Review ▶ 6. Process ▶ 7. Complete

The course was restored successfully, clicking the continue button below will take you to view the course you restored.

Continue